



Fashion...Quality...Value...and Safety™

“...finding solutions for families, especially busy moms.”™



www.omnialeather.com www.kathyireland.com

# City Craft

Americana

01/03/2010

## Standard & Armless

(All 4 seat items ship as one piece if stationary, two pieces if motion installed)

## 2 Piece Curve Sectional & Ottomans

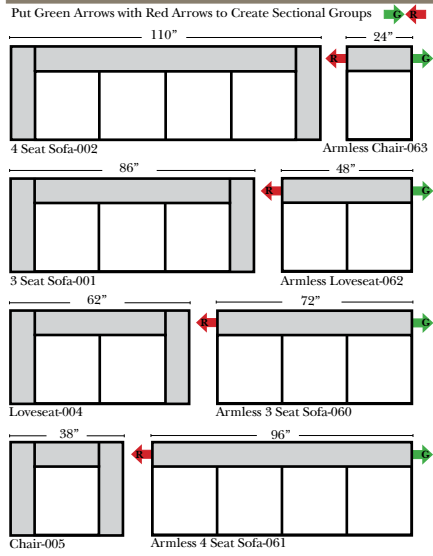

Put Blue Arrows with Yellow Arrows to Create Sectional Groups or Green Arrows with Red Arrows mix with some of the L-Shaped pieces.

**2 Piece Curve Sectionals**  
for this style not available  
at this time

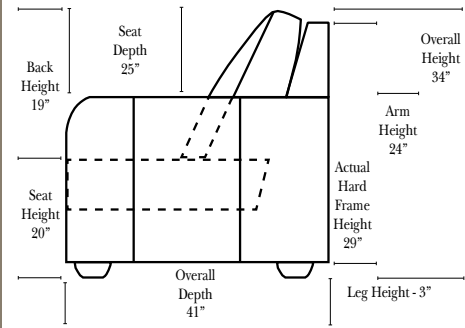
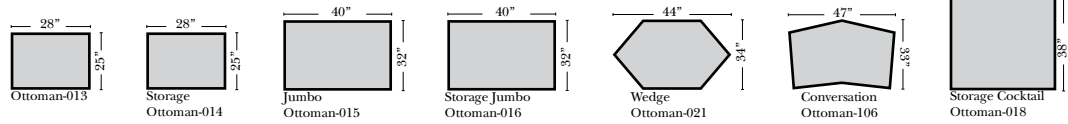

### Features

- Standard:**
- Available in Full & Top Grain Leathers
  - Available in Luxury Fabrics
  - All Hardwood Frames
- Options:**
- Down Seats & Down Backs (additional Charge)
  - No. 33 Firm Foam
- Sleeper Options: (All the below options are at additional charges)**
- Queen Sleeper available w/Standard Mattress
  - Twin Sleeper available w/Standard Mattress
  - Deluxe Innerspring Mattress: Queen / Twin
  - Air Dream Coil Mattress: Queen Only
  - Hideaway Air Mattress: Queen Only

## L-Shape / 90 Degree Sectional

(All 4 seat items ship as one piece if stationary, two pieces if motion installed)

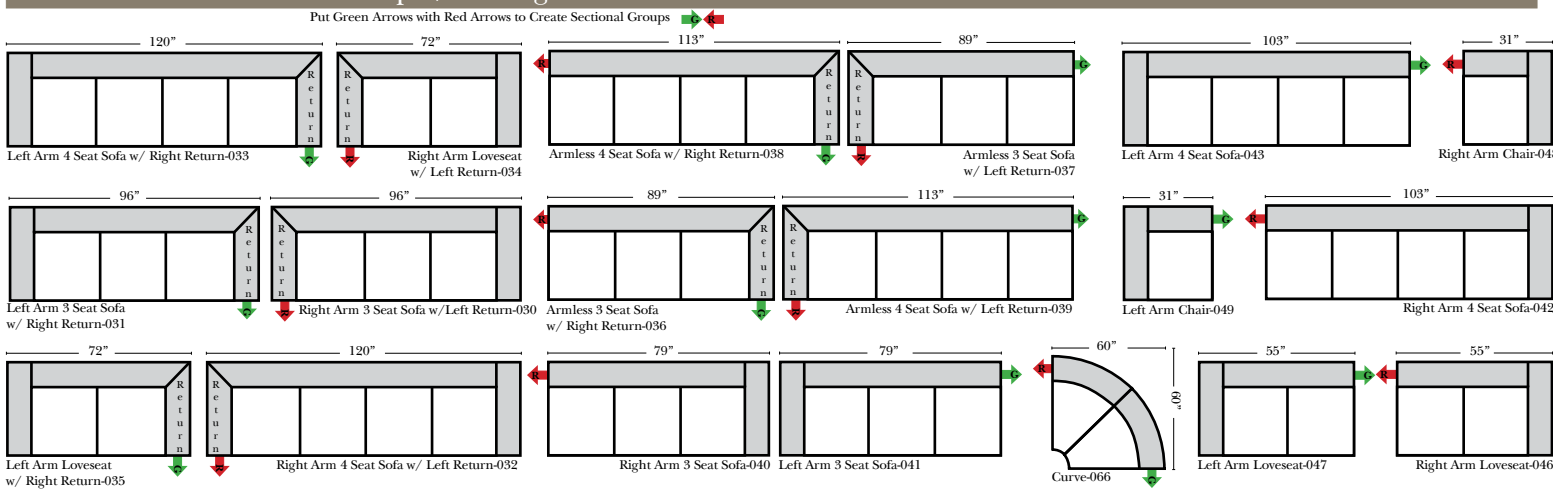

### Note:

All Dimensions are approximate, if accuracy is crucial, please contact us for validation of the dimensions shown. However, a 1" to 2" variance can still apply due to foam and upholstery.





# City Craft

Americana

01/03/2010

## Chaise & Conversation Sectionals

Put Green Arrows with Red Arrows to Create Sectional Groups  
Put Orange Arrows with Tan Arrows to Create Sectional Groups

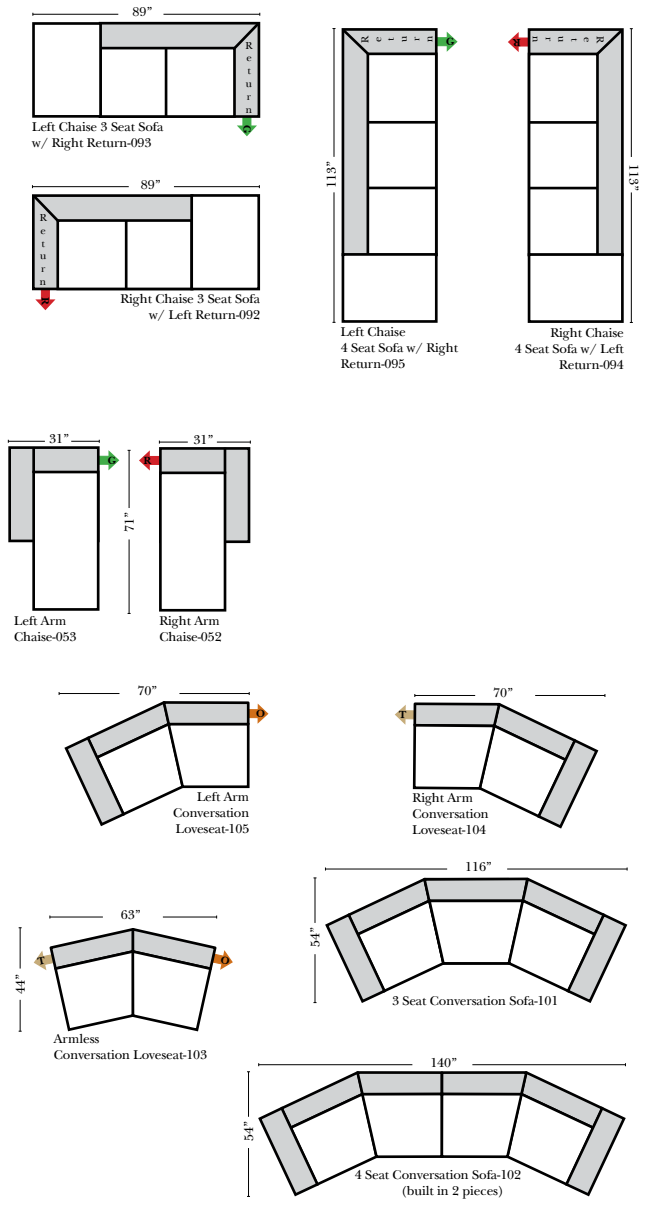

## Sleepers

Put Green Arrows with Red Arrows to Create Sectional Groups  
Put Blue Arrows with Yellow Arrows to Create Sectional Groups

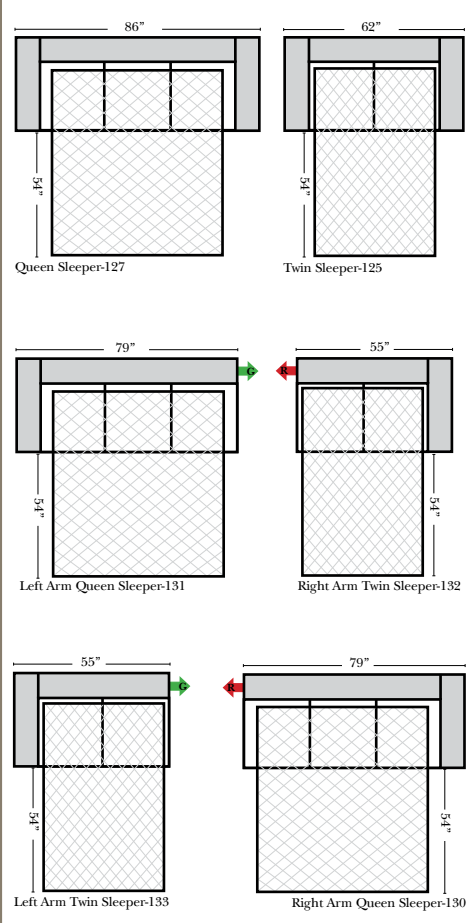

## Suggested Configurations

The Suggested Configurations below are only a sample of what the imagination can create, please enjoy creating the configuration that fits your lifestyle, using the ideas below and from the items on the opposite page.

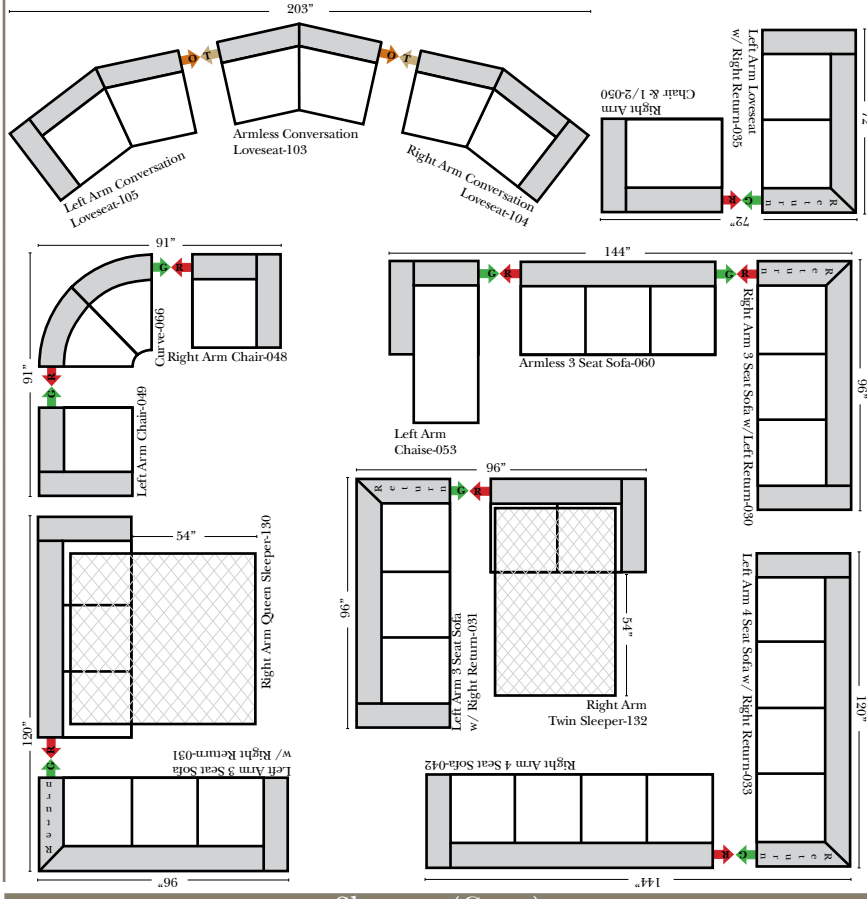

## Sleepers (Cont.)